

# Stanway Quarry Fiveways Fruit Farm Extension

**Restoration Aims**

The Main Aims of the Restoration Scheme are :-

1. To produce a landform and landuse scheme that is capable of not only integration into but enhancement of the local landscape character.
2. To create new habitat to provide opportunity for sustainable long term biodiversity within the site and the local area.
3. To minimise the amount of material that will be required to restore the site from off site sources.
4. To allow for the progressive restoration of Fiveways Fruit Farm utilising on-site restoration materials only.

The approximate volume of restoration material required to achieve this scheme = 2.91 million m<sup>3</sup>

569,000 m<sup>3</sup> to Five Ways Fruit Farm  
2,350,000 m<sup>3</sup> to Main Stanway Hall Void/Batters

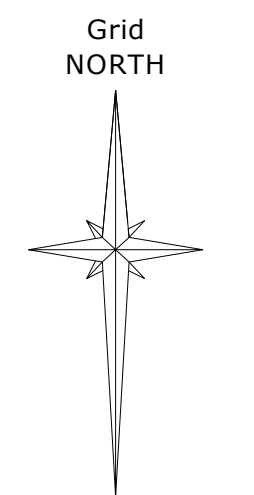
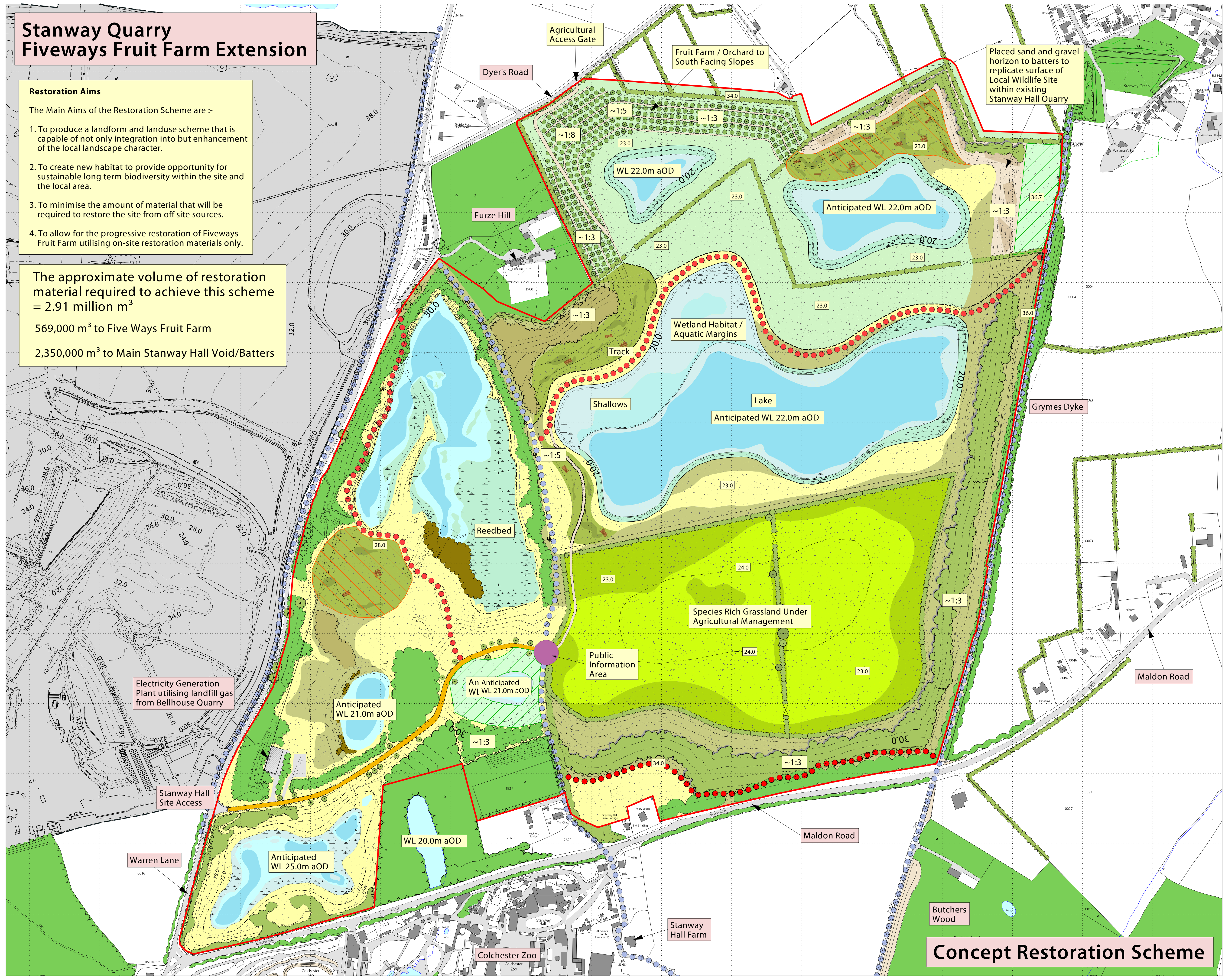

Based on Ordnance Survey Digital Data with permission from The Controller of Her Majesty's Stationery Office. Crown Copyright Licence No. 100019980. Lafarge Tarmac, Portland House, Solihull, B37 7BQ

- Legend**
- Planning Permission Boundary
  - Proposed Broadleaf Dry Woodland
  - Proposed Dry Scrub
  - Proposed Orchard
  - Existing Woodland / Hedgerows
  - Proposed Acid Grassland
  - Proposed Species Rich Grassland
  - Proposed Agricultural Grassland
  - Proposed Mosaic Wildlife / Reptile Habitat
  - Sand and Gravel Horizon / Bare Ground
  - Proposed Hedgerows
  - Fencing
  - Proposed Agricultural Access Track
  - Proposed Vehicle Access Track
  - Developing Reedbed / Wet Woodland
  - Aquatic Marginal Vegetation
  - Proposed Open Water
  - Reptile Translocation Area
  - Jersey Cudweed Protection Area
  - Existing Public Rights of Way
  - Proposed Permissive Footpaths



**Stanway Quarry**  
Fiveways Fruit Farm  
Extension  
Concept Restoration Scheme

Scale when Printed A1: <b>1:2,500</b>	Drawing Number: <b>B030/00639</b>
Draughtsman: <b>L.BATES</b>	Date of First Issue: <b>12/06/2014</b>
Drawing Edition: <b>FINAL</b>	

## Concept Restoration Scheme